



CITIZEN



## Plot 157 Astley Fields "SO2" - 40% Share

34 Lilah Way, Bedworth, CV12 0QN

**40% Shared ownership £96,500**



# Plot 157 Astley Fields

## Spring time offers on selected homes



\*Offers apply to selected homes, not all offers apply to one property please contact our sales team for more information (5% deposit paid applies to advertised share only)

Contact our sales team- [sales@citizenhousing.org.uk](mailto:sales@citizenhousing.org.uk)  
or visit our website - [www.signaturenewhomes.co.uk](http://www.signaturenewhomes.co.uk)



Plot 157 Astley Fields - Purchase Price 40% share £96,500 Total Rent £368.90 pcm

READY TO OCCUPY

If you would like to apply for this property, please complete our online application form via our Signature Website

\* Images are for illustration purposes only

- New Build
- Downstairs Cloakroom
- Vinyl flooring to wet areas
- Gas central heating near Coventry
- Semi Detached
- Two bedrooms
- Oven, hob & extractor included
- Turf to rear garden
- Good transport links



# Plot 157 Astley Fields



## Floor Plan

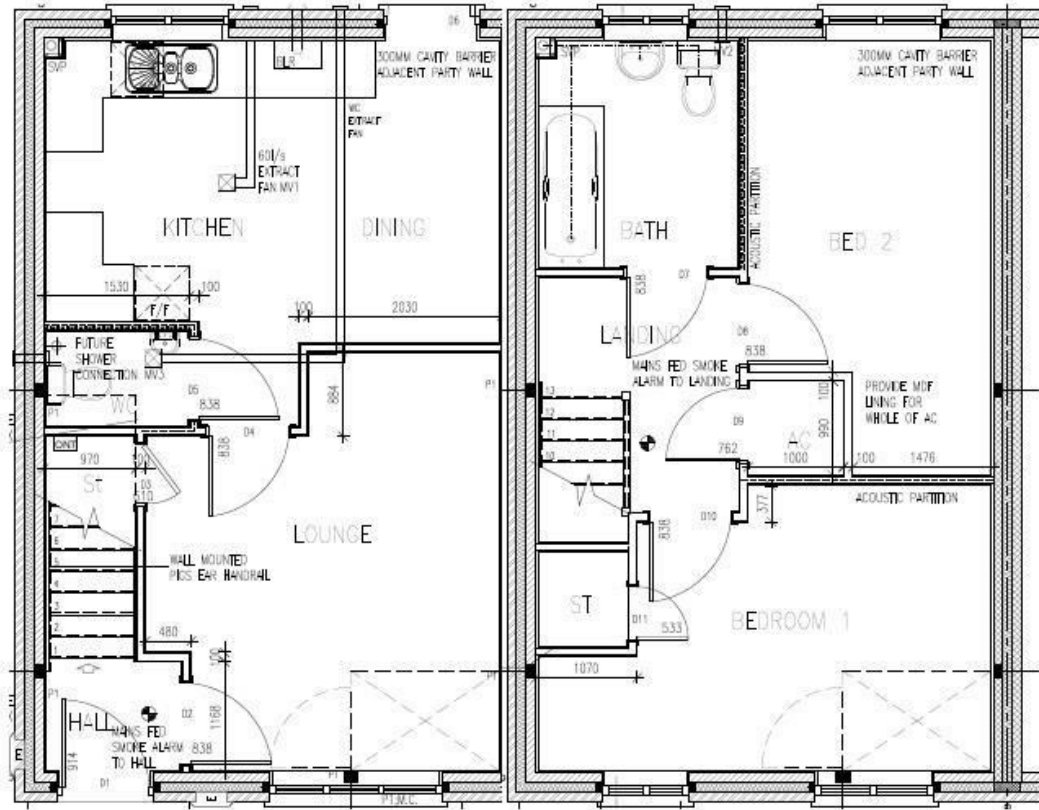

## Area Map

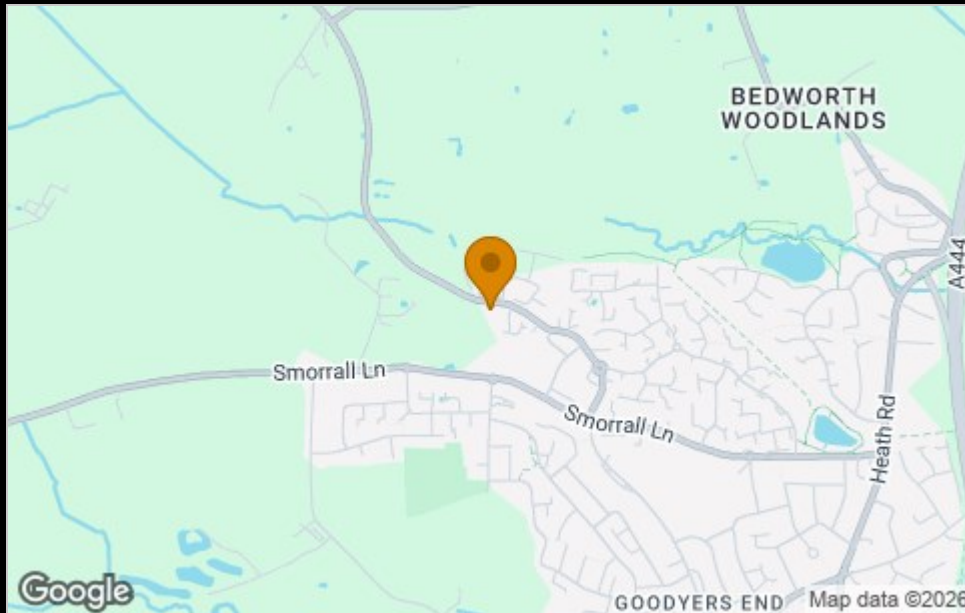

Please contact our sales team at [sales@citizenhousing.org.uk](mailto:sales@citizenhousing.org.uk) if you wish to arrange a viewing for this property or if you require further information.

## Energy Efficiency Graph

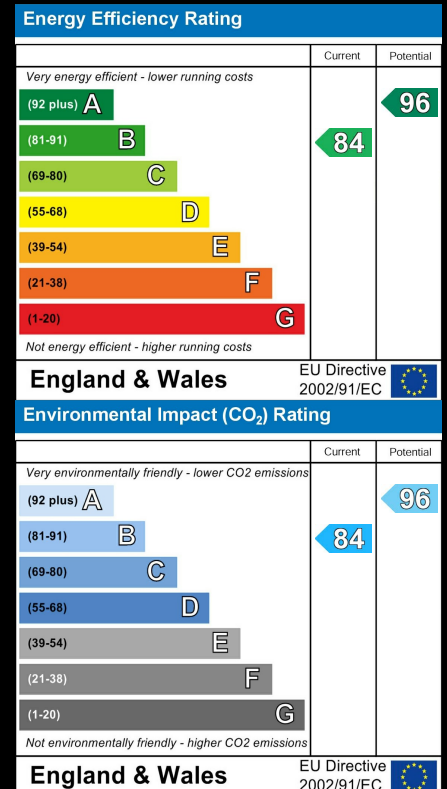

These particulars, whilst believed to be accurate are set out as a general outline only for guidance and do not constitute any part of an offer or contract. Intending purchasers should not rely on them as statements of representation of fact, but must satisfy themselves by inspection or otherwise as to their accuracy. No person in this firm's employment has the authority to make or give any representation or warranty in respect of the property.

4040 Lakeside, Solihull, West Midlands, B37 7YN

Email: [sales@citizenhousing.org.uk](mailto:sales@citizenhousing.org.uk) or visit [www.citizenhousing.org.uk](http://www.citizenhousing.org.uk)