



## Plot 186 Park Gate - 40% share "The Hardwick"

10 Whitebeam Close, Lea Castle, Kidderminster, DY10 3GP

**40% Shared ownership £95,598**



2



1



1



B



# Plot 186 Park Gate - 40% share "The Hardwick"

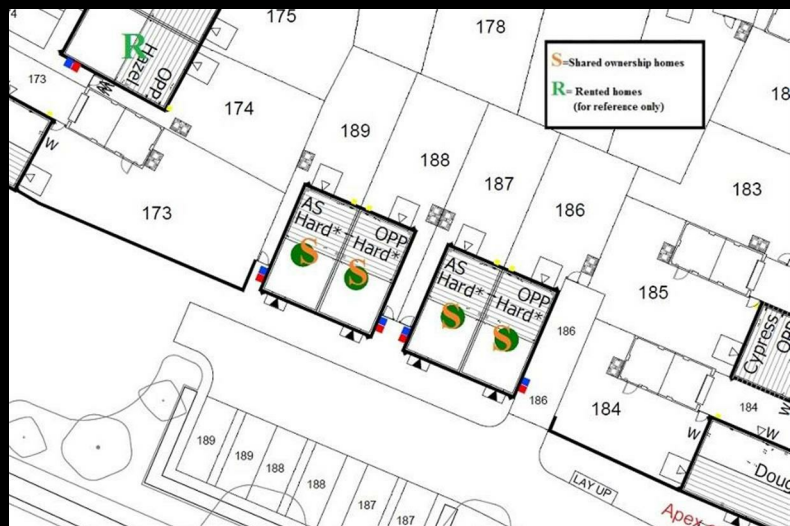

## Description

Plot 186-Park Gate - 40% share available £95,598  
Total Rent £382.35 pcm

Ready to Occupy January/February 2025 - AVAILABLE TO RESERVE NOW

If you would like to apply for this property, please complete our online application form via our Signature Website

You will need to also register with the local authority to purchase a property on this development, please visit - [www.homechoiceplus.org.uk/householdregistrationform](http://www.homechoiceplus.org.uk/householdregistrationform)

- Vinyl flooring to wet areas
- En suite to master bedroom
- Turf to front and rear gardens
- 1.8m Fencing to rear gardens
- 2 Parking spaces
- 2 spacious bedrooms
- Semi detached
- Downstairs cloakroom
- Brushed steel oven, ceramic hob & extractor
- near Kidderminster



Floor Plan

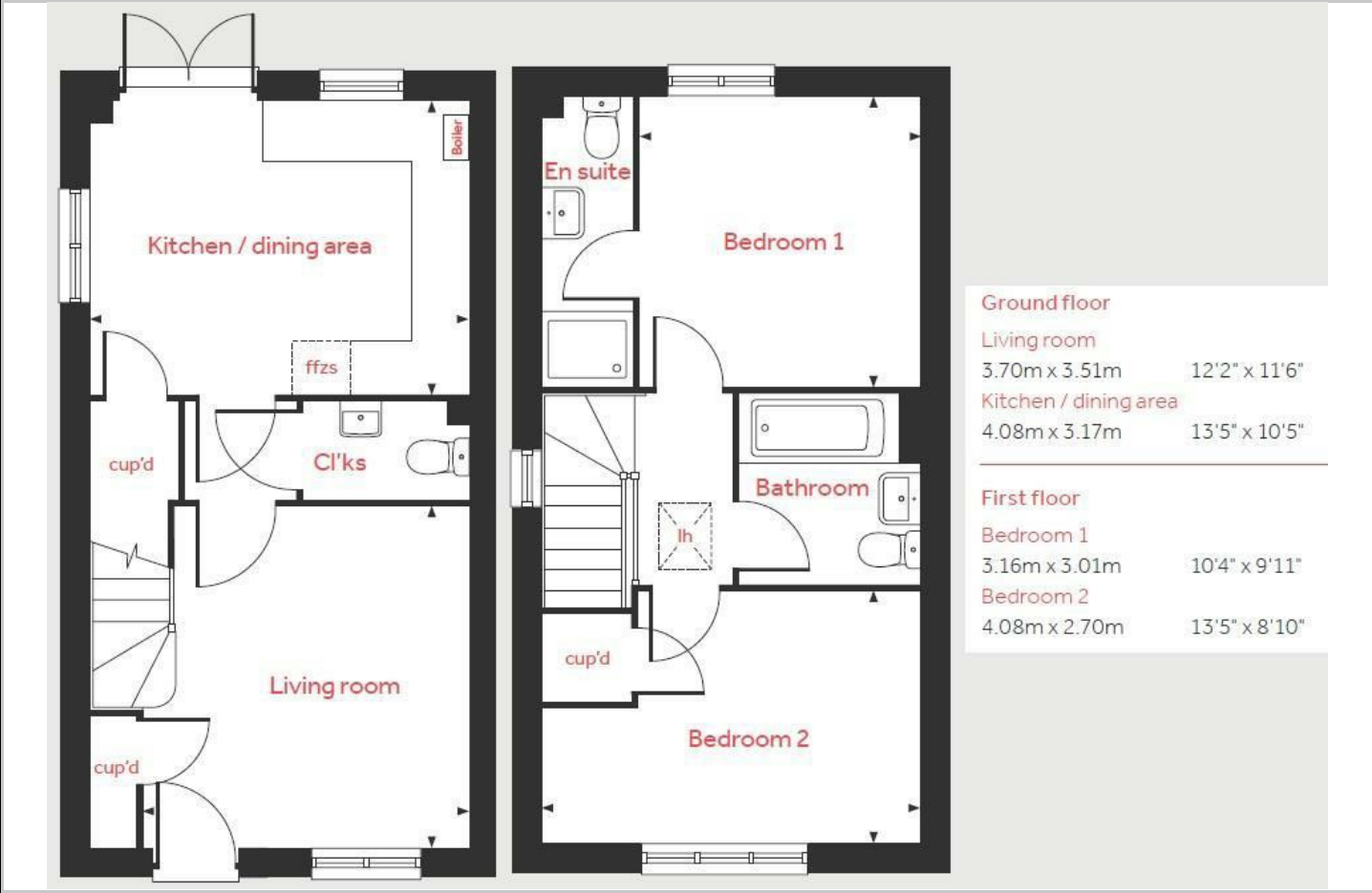

Area Map

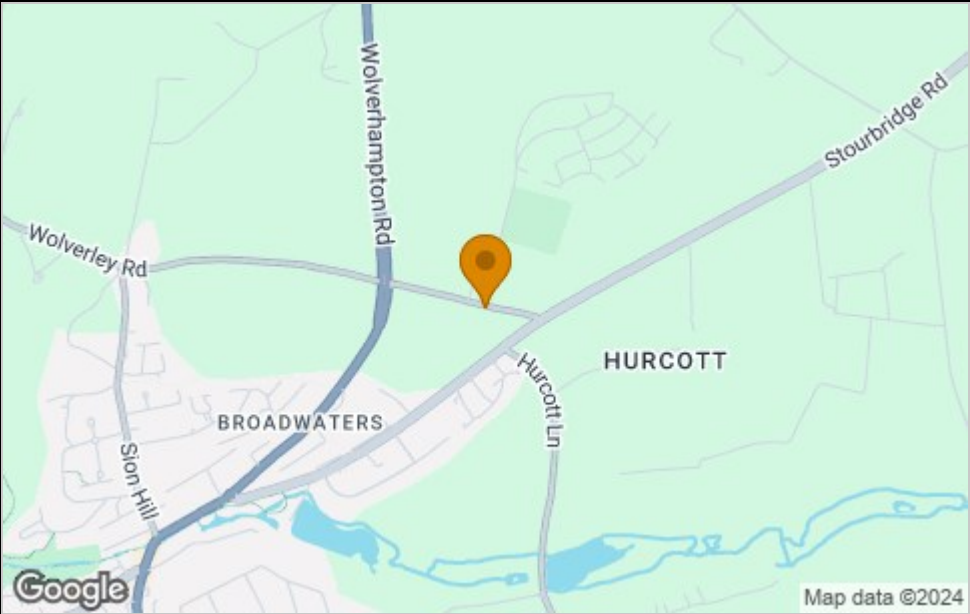

**Viewing**  
Please contact Sales Advisor Kellie on 07807 787747 if you wish to arrange a viewing appointment for this property or require further information.

Energy Efficiency Graph

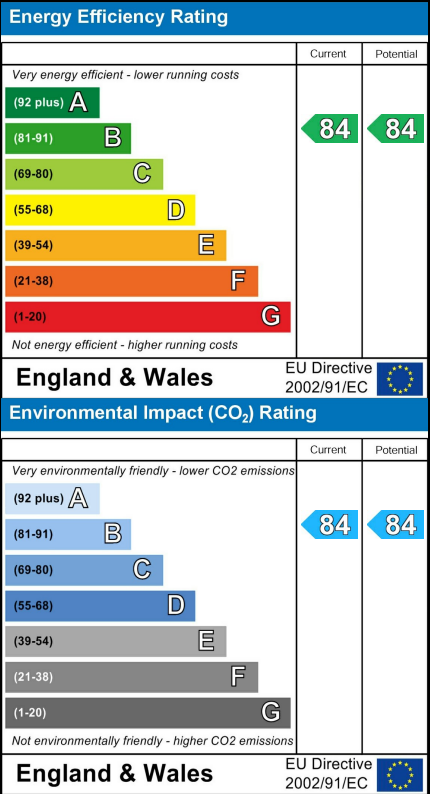

These particulars, whilst believed to be accurate are set out as a general outline only for guidance and do not constitute any part of an offer or contract. Intending purchasers should not rely on them as statements of representation of fact, but must satisfy themselves by inspection or otherwise as to their accuracy. No person in this firms employment has the authority to make or give any representation or warranty in respect of the property.

4040 Lakeside, Solihull, West Midlands, B37 7YN  
Email: sales@citizenhousing.org.uk or visit www.citizenhousing.org.uk





## Plot 187 Park Gate - 40% share "The Hardwick"

12 Whitebeam Close, Lea Castle, Kidderminster, DY10 3GP

**40% Shared ownership £96,598**



2



1



1



B



# Plot 187 Park Gate - 40% share "The Hardwick"

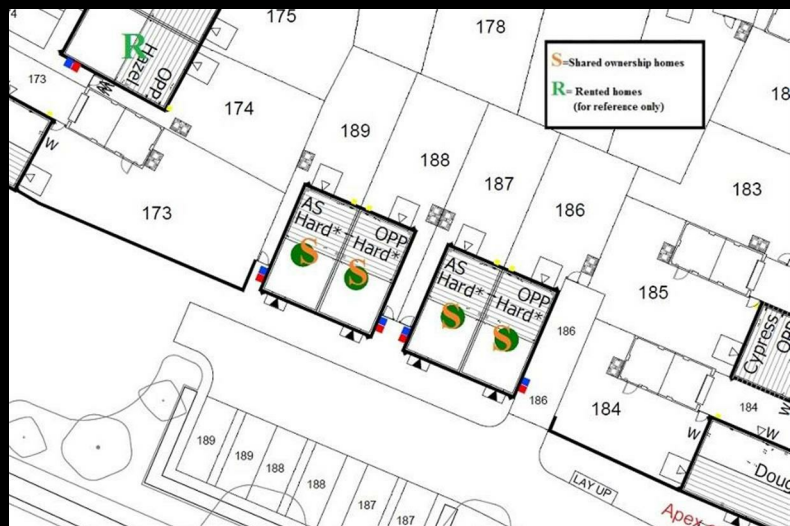

## Description

Plot 187-Park Gate - 40% share available £96,598  
Total Rent £385.79 pcm

Ready to Occupy January/February 2025 - AVAILABLE TO RESERVE NOW

If you would like to apply for this property, please complete our online application form via our Signature Website

You will need to also register with the local authority to purchase a property on this development, please visit - [www.homechoiceplus.org.uk/householdregistrationform](http://www.homechoiceplus.org.uk/householdregistrationform)

- Vinyl flooring to wet areas
- En suite to master bedroom
- Turf to front and rear gardens
- 1.8m Fencing to rear gardens
- 2 Parking spaces
- 2 spacious bedrooms
- Semi detached
- Downstairs cloakroom
- Brushed steel oven, ceramic hob & extractor
- near Kidderminster





Floor Plan



Area Map



**Viewing**  
Please contact our Sales Advisor Kellie on 07807 787747 if you wish to arrange a viewing appointment for this property or require further information.

Energy Efficiency Graph

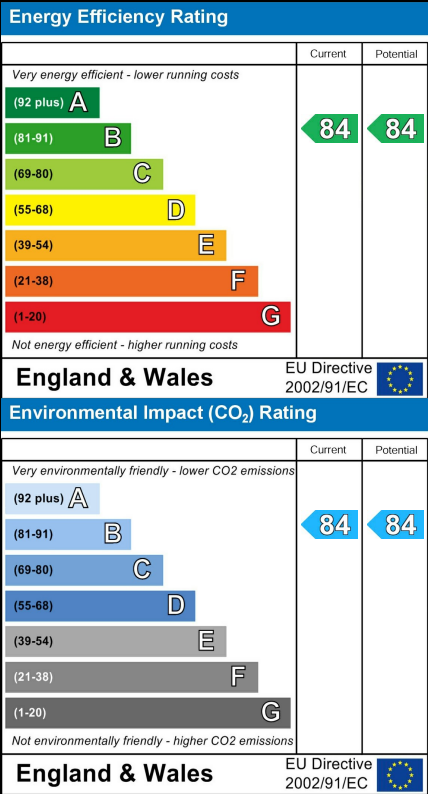

These particulars, whilst believed to be accurate are set out as a general outline only for guidance and do not constitute any part of an offer or contract. Intending purchasers should not rely on them as statements of representation of fact, but must satisfy themselves by inspection or otherwise as to their accuracy. No person in this firms employment has the authority to make or give any representation or warranty in respect of the property.

4040 Lakeside, Solihull, West Midlands, B37 7YN  
Email: [sales@citizenhousing.org.uk](mailto:sales@citizenhousing.org.uk) or visit [www.citizenhousing.org.uk](http://www.citizenhousing.org.uk)





## Plot 188 Park Gate - 40% share "The Hardwick"

14 Whitebeam Close, Lea Castle, Kidderminster, DY10 3GP

**40% Shared ownership £96,958**



2



1



1



B



# Plot 188 Park Gate - 40% share "The Hardwick"

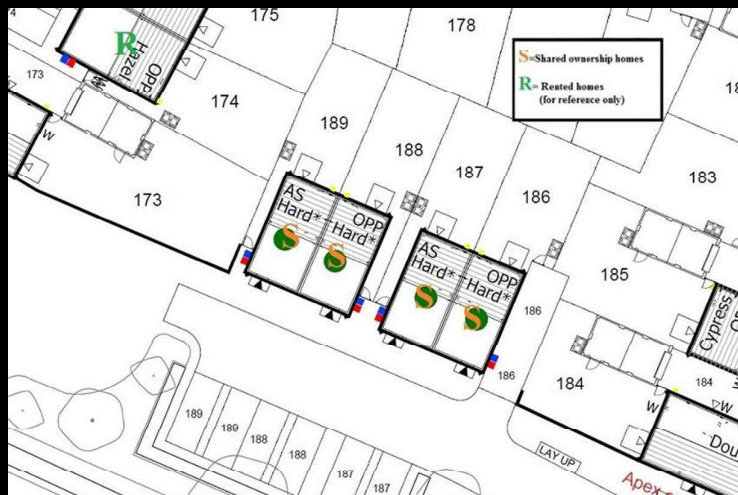

## Description

Plot 188-Park Gate - 40% share available £96,598  
Total Rent £385.79 pcm

Ready to Occupy January/February 2025 - AVAILABLE TO RESERVE NOW

If you would like to apply for this property, please complete our online application form via our Signature Website

You will need to also register with the local authority to purchase a property on this development, please visit - [www.homechoiceplus.org.uk/householdregistrationform](http://www.homechoiceplus.org.uk/householdregistrationform)

- Vinyl flooring to wet areas
- En suite to master bedroom
- Turf to front and rear gardens
- 1.8m Fencing to rear
- 2 Parking spaces
- 2 spacious bedrooms
- Semi detached
- Downstairs cloakroom
- Brushed steel oven, ceramic hob & extractor
- near Kidderminster



Floor Plan



Area Map



**Viewing**  
Please contact our Sales advisor Kellie on 07807 787747, if you wish to arrange a viewing appointment for this property

Energy Efficiency Graph

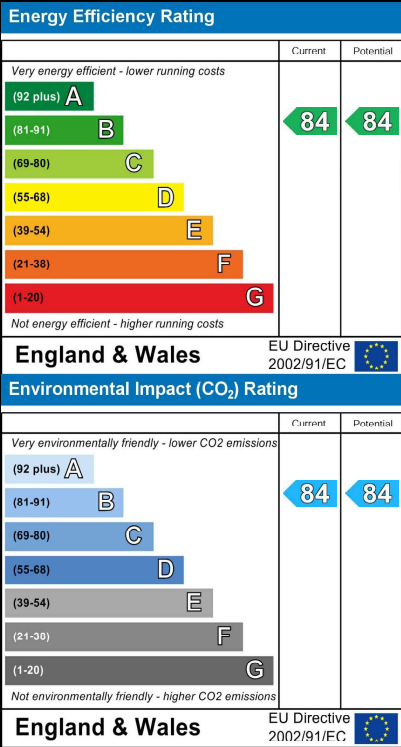

These particulars, whilst believed to be accurate are set out as a general outline only for guidance and do not constitute any part of an offer or contract. Intending purchasers should not rely on them as statements of representation of fact, but must satisfy themselves by inspection or otherwise as to their accuracy. No person in this firms employment has the authority to make or give any representation or warranty in respect of the property.

**4040 Lakeside, Solihull, West Midlands, B37 7YN**  
**Email: [sales@citizenhousing.org.uk](mailto:sales@citizenhousing.org.uk) or visit [www.citizenhousing.org.uk](http://www.citizenhousing.org.uk)**





## Plot 189 Park Gate - 40% share "The Hardwick"

16 Whitebeam Close, Lea Castle, Kidderminster, DY10 3GP

**40% Shared ownership £95,598**



2



1



1



B



# Plot 189 Park Gate - 40% share "The Hardwick"

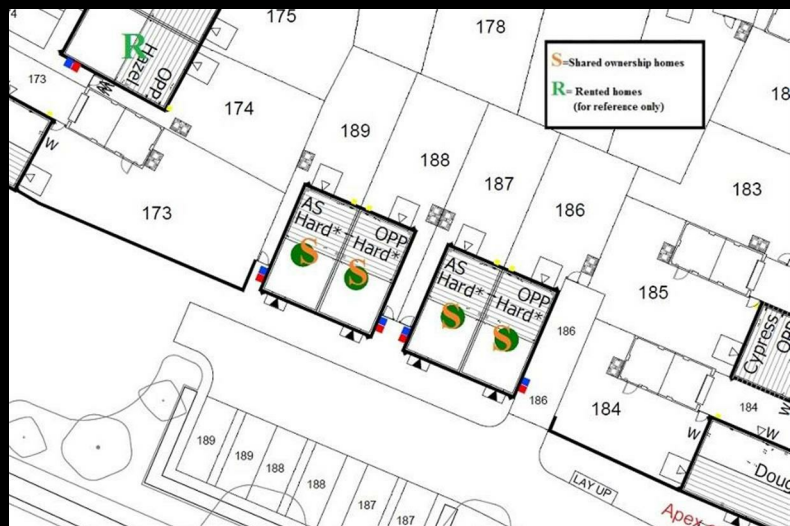

## Description

Plot 189-Park Gate - 40% share available £95,598  
Total Rent £382.35 pcm

Ready to Occupy January/February 2025 - AVAILABLE TO RESERVE NOW

If you would like to apply for this property, please complete our online application form via our Signature Website

You will need to also register with the local authority to purchase a property on this development, please visit - [www.homechoiceplus.org.uk/householdregistrationform](http://www.homechoiceplus.org.uk/householdregistrationform)

- Vinyl flooring to wet areas
- En suite to master bedroom
- Turf to front and rear gardens
- 1.8m Fencing to rear gardens
- 2 Parking spaces
- 2 spacious bedrooms
- Semi detached
- Downstairs cloakroom
- Brushed steel oven, ceramic hob & extractor
- near Kidderminster





Floor Plan



Area Map

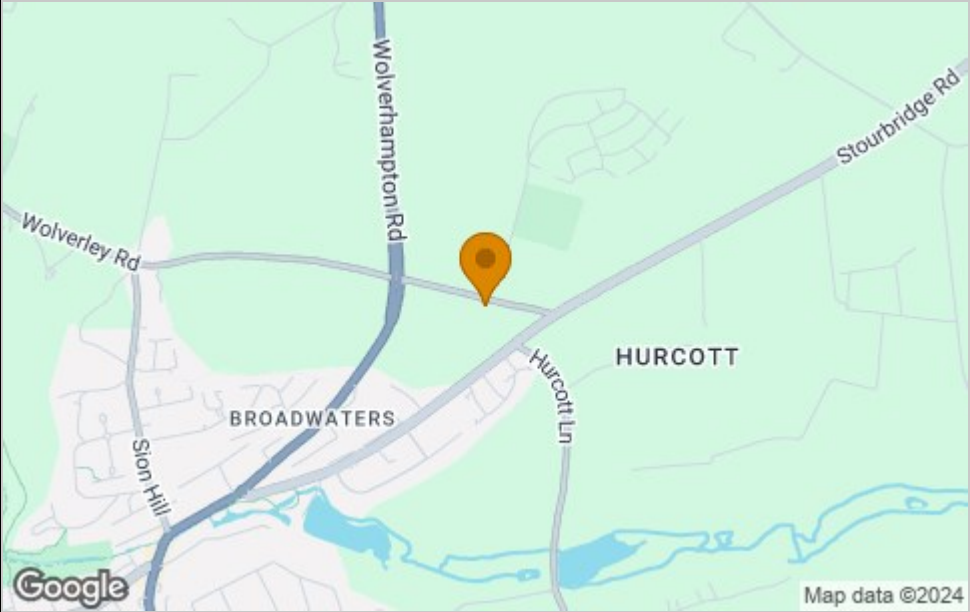

**Viewing**  
Please contact our Sales Advisor Kellie on 07807 787747 if you wish to arrange a viewing appointment for this property or require further information.

Energy Efficiency Graph

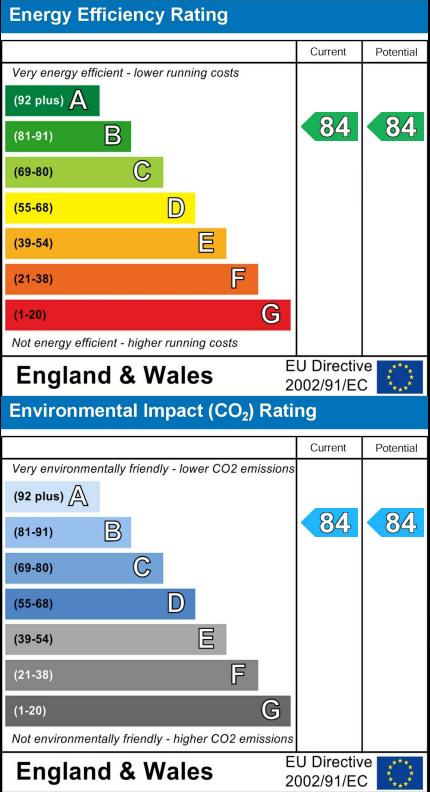

These particulars, whilst believed to be accurate are set out as a general outline only for guidance and do not constitute any part of an offer or contract. Intending purchasers should not rely on them as statements of representation of fact, but must satisfy themselves by inspection or otherwise as to their accuracy. No person in this firms employment has the authority to make or give any representation or warranty in respect of the property.

4040 Lakeside, Solihull, West Midlands, B37 7YN  
Email: sales@citizenhousing.org.uk or visit www.citizenhousing.org.uk



## Plot 307 Park Gate- "The Francis" 35% share

15 Bluebell Crescent, Lea Castle, Kidderminster, DY10 3FD

**35% Shared ownership £99,925**



3



1



1



B



# Plot 307 Park Gate- "The Francis" 35% share

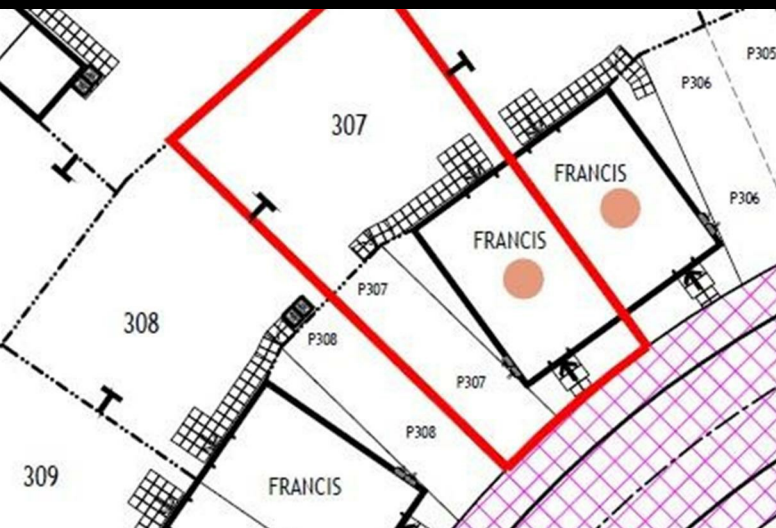

## Description

Plot 307 Park Gate "Francis" Purchase Price £99,925 35% share  
Total Rent £480.79 pcm

READY TO OCCUPY

If you would like to apply for this property, please complete our online application form via our Signature Website

You will need to also register with the local authority to purchase a property on this development, please visit - [www.homechoiceplus.org.uk/householdregistrationform](http://www.homechoiceplus.org.uk/householdregistrationform)

- Vinyl flooring to wet areas
- Turf to front and rear gardens
- 2 Parking spaces
- Semi Detached
- Brushed steel oven, hob & extractor
- New Build
- 1.8m Fencing to rear gardens
- Ensuite to master bedroom
- Downstairs cloakroom
- Near Kidderminster



Floor Plan

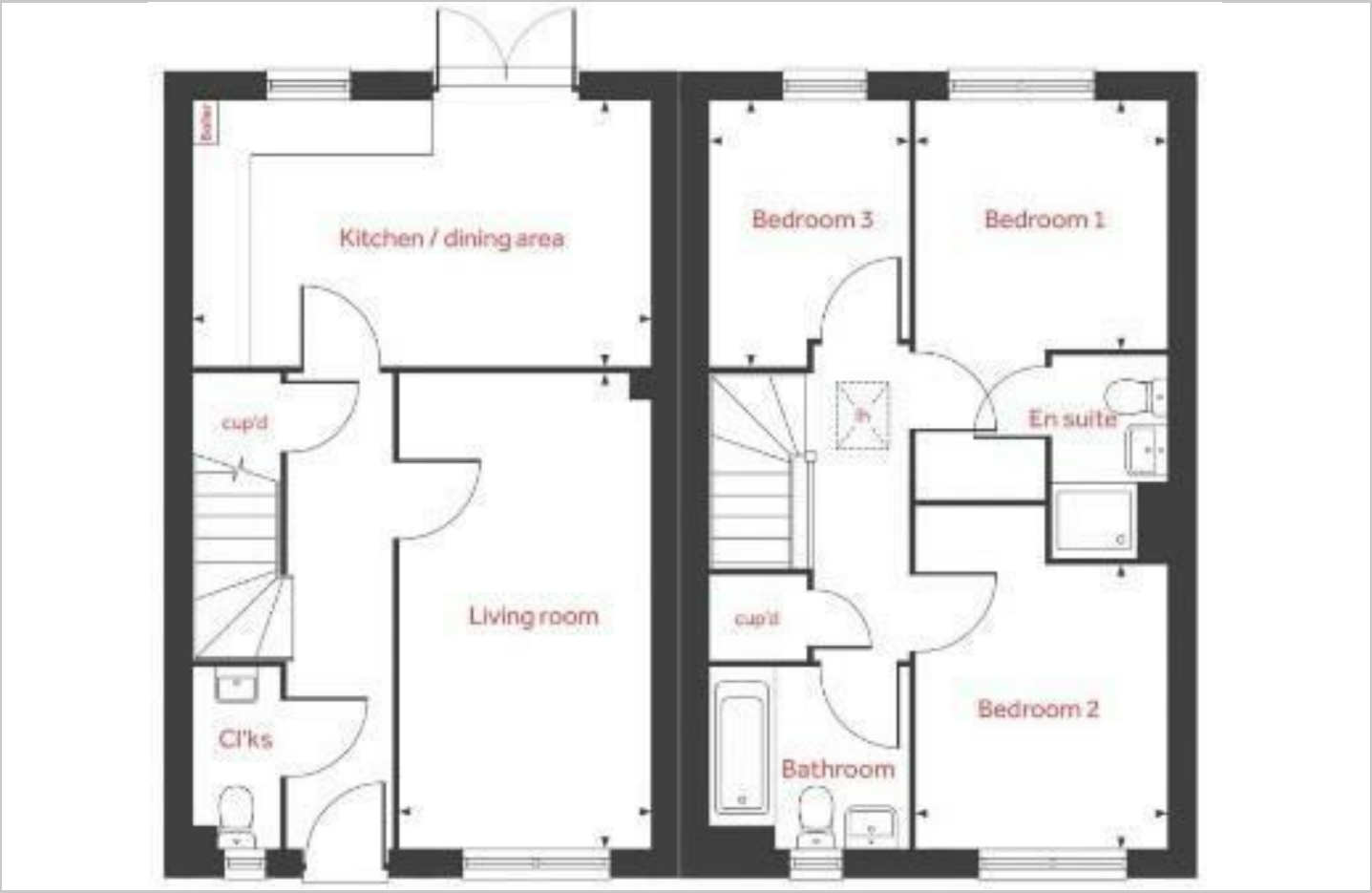

Area Map

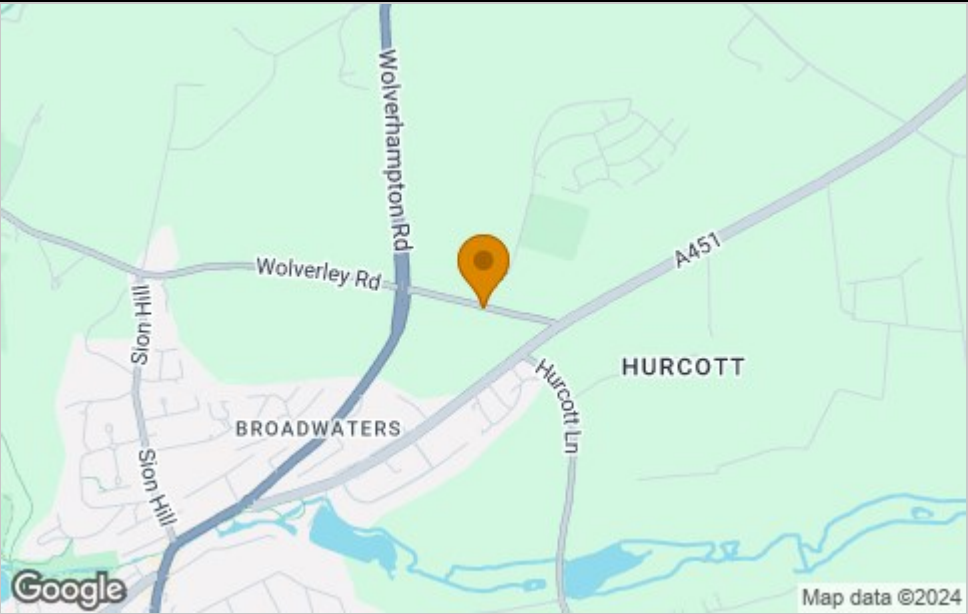

Viewing

Please contact our Sales Advisor Kellie on 07807 787747 if you wish to arrange a viewing appointment for this property or require further information.

Energy Efficiency Graph

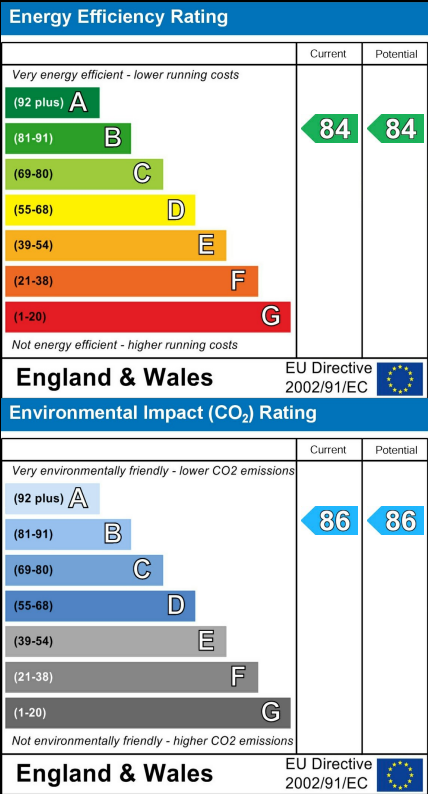

These particulars, whilst believed to be accurate are set out as a general outline only for guidance and do not constitute any part of an offer or contract. Intending purchasers should not rely on them as statements of representation of fact, but must satisfy themselves by inspection or otherwise as to their accuracy. No person in this firms employment has the authority to make or give any representation or warranty in respect of the property.

4040 Lakeside, Solihull, West Midlands, B37 7YN  
Email: sales@citizenhousing.org.uk or visit www.citizenhousing.org.uk



