



## Plot 278 Park Gate - 40% share "The Hardwick"

4 Fern Close, Lea Castle, Kidderminster, DY10 3FU

**40% Shared ownership £95,598**



2



1



1



B

# Plot 278 Park Gate - 40% share "The Hardwick"



## Description

Plot 2278-Park Gate - 40% share available £95,598  
Total Rent £382.34 pcm

Ready to Occupy October 2024 - AVAILABLE TO RESERVE NOW

If you would like to apply for this property, please complete our online application form via our Signature Website

You will need to also register with the local authority to purchase a property on this development, please visit - [www.homechoiceplus.org.uk/householdregistrationform](http://www.homechoiceplus.org.uk/householdregistrationform)

- Vinyl flooring to wet areas
- En suite to master bedroom
- Turf to front and rear gardens
- 1.8m Fencing to rear gardens
- 2 Parking spaces
- 2 spacious bedrooms
- Semi detached
- Downstairs cloakroom
- Brushed steel oven, ceramic hob & extractor
- near Kidderminster

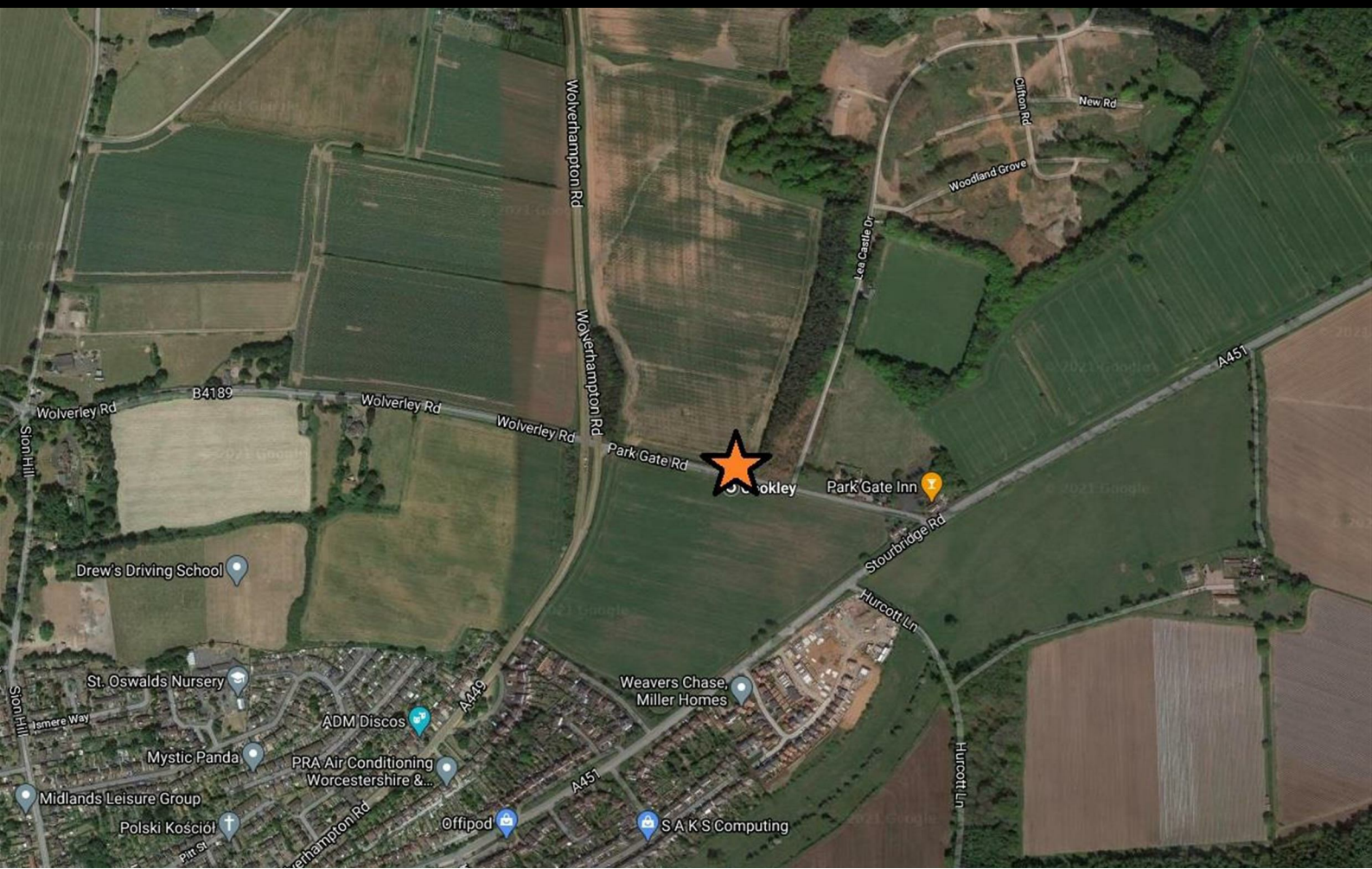

Floor Plan



Area Map

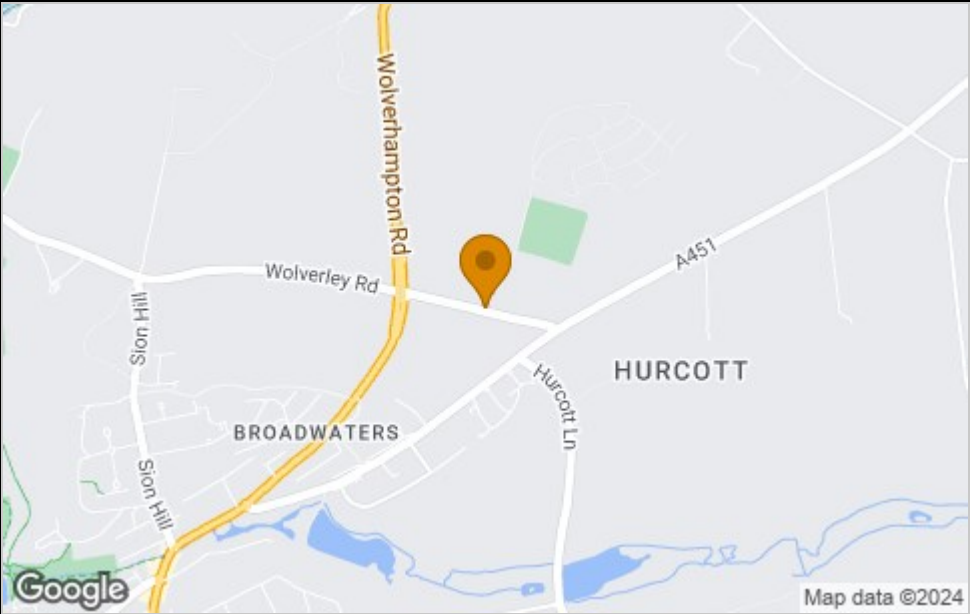

**Viewing**  
Please contact our Sales Advisor Kellie on 07807 787747 if you wish to arrange a viewing appointment for this property or require any further information.

Energy Efficiency Graph

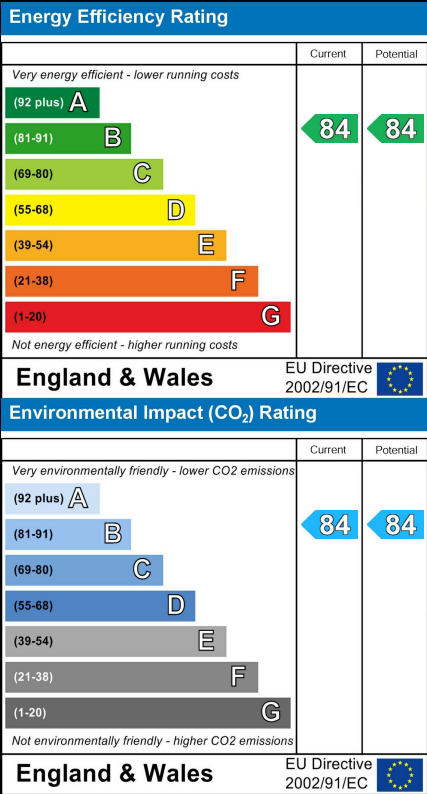

These particulars, whilst believed to be accurate are set out as a general outline only for guidance and do not constitute any part of an offer or contract. Intending purchasers should not rely on them as statements of representation of fact, but must satisfy themselves by inspection or otherwise as to their accuracy. No person in this firms employment has the authority to make or give any representation or warranty in respect of the property.

4040 Lakeside, Solihull, West Midlands, B37 7YN  
Email: [sales@citizenhousing.org.uk](mailto:sales@citizenhousing.org.uk) or visit [www.citizenhousing.org.uk](http://www.citizenhousing.org.uk)



## Plot 279 Park Gate - 40% share "The Hardwick"

6 Fern Close, Lea Castle, Kidderminster, DY10 3FU

**40% Shared ownership £95,598**



2



1



1



B

# Plot 279 Park Gate - 40% share "The Hardwick"



## Description

Plot 279-Park Gate - 40% share available £95,598  
Total Rent £382.34 pcm

Ready to Occupy October 2024 - AVAILABLE TO RESERVE NOW

If you would like to apply for this property, please complete our online application form via our Signature Website

You will need to also register with the local authority to purchase a property on this development, please visit - [www.homechoiceplus.org.uk/householdregistrationform](http://www.homechoiceplus.org.uk/householdregistrationform)

- Vinyl flooring to wet areas
- En suite to master bedroom
- Turf to front and rear gardens
- 1.8m Fencing to rear gardens
- 2 Parking spaces
- 2 spacious bedrooms
- Semi detached
- Downstairs cloakroom
- Brushed steel oven, ceramic hob & extractor
- near Kidderminster

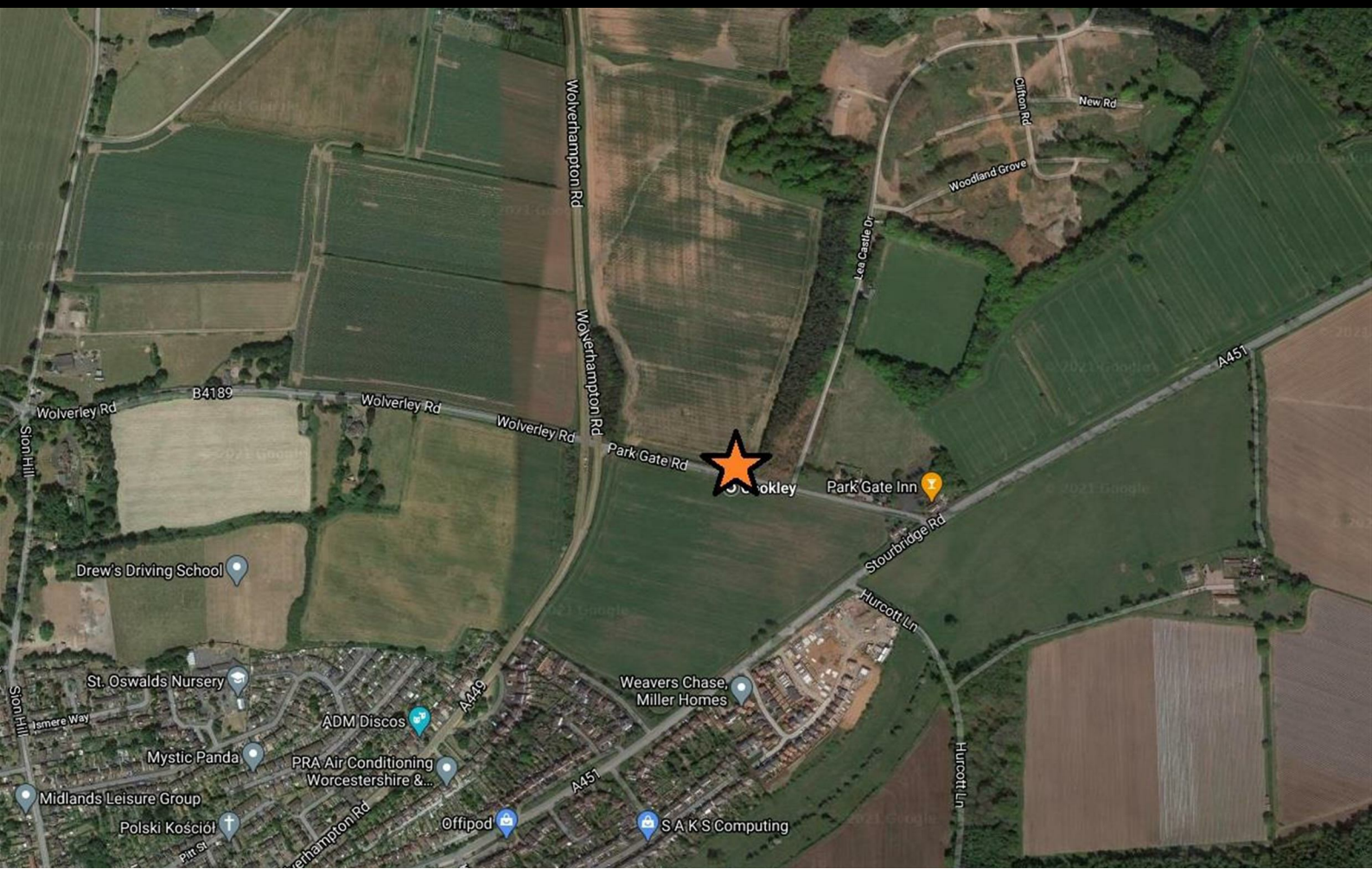

Floor Plan



Area Map



Energy Efficiency Graph

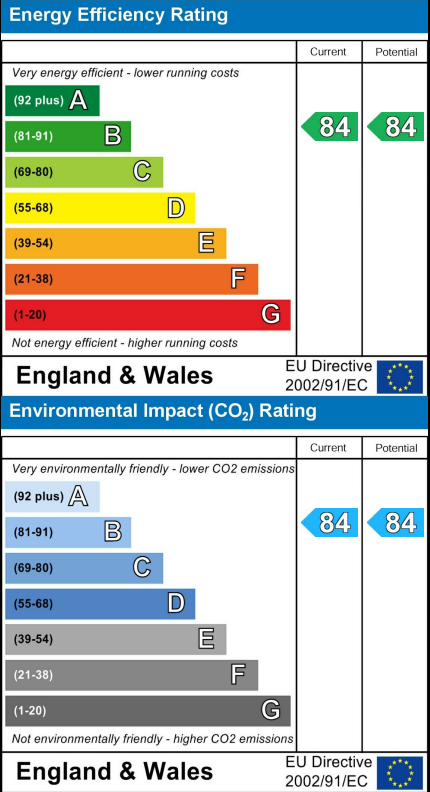

Viewing

Please contact our Sales Advisor Kellie on 07807 787747 if you wish to arrange a viewing appointment for this property or require any further information.

These particulars, whilst believed to be accurate are set out as a general outline only for guidance and do not constitute any part of an offer or contract. Intending purchasers should not rely on them as statements of representation of fact, but must satisfy themselves by inspection or otherwise as to their accuracy. No person in this firms employment has the authority to make or give any representation or warranty in respect of the property.

4040 Lakeside, Solihull, West Midlands, B37 7YN  
Email: sales@citizenhousing.org.uk or visit www.citizenhousing.org.uk



## Plot 285 Park Gate - 40% share "The Hardwick"

5 Fern Close, Lea Castle, Kidderminster, DY10 3FU

**40% Shared ownership £95,598**



2



1



1



B

# Plot 285 Park Gate - 40% share "The Hardwick"



## Description

Plot 285-Park Gate - 40% share available £95,598  
Total Rent £382.34 pcm

Ready to Occupy October 2024 - AVAILABLE TO RESERVE NOW

If you would like to apply for this property, please complete our online application form via our Signature Website

You will need to also register with the local authority to purchase a property on this development, please visit - [www.homechoiceplus.org.uk/householdregistrationform](http://www.homechoiceplus.org.uk/householdregistrationform)

- Vinyl flooring to wet areas
- En suite to master bedroom
- Turf to front and rear gardens
- 1.8m Fencing to rear gardens
- 2 Parking spaces
- 2 spacious bedrooms
- Semi detached
- Downstairs cloakroom
- Brushed steel oven, ceramic hob & extractor
- near Kidderminster

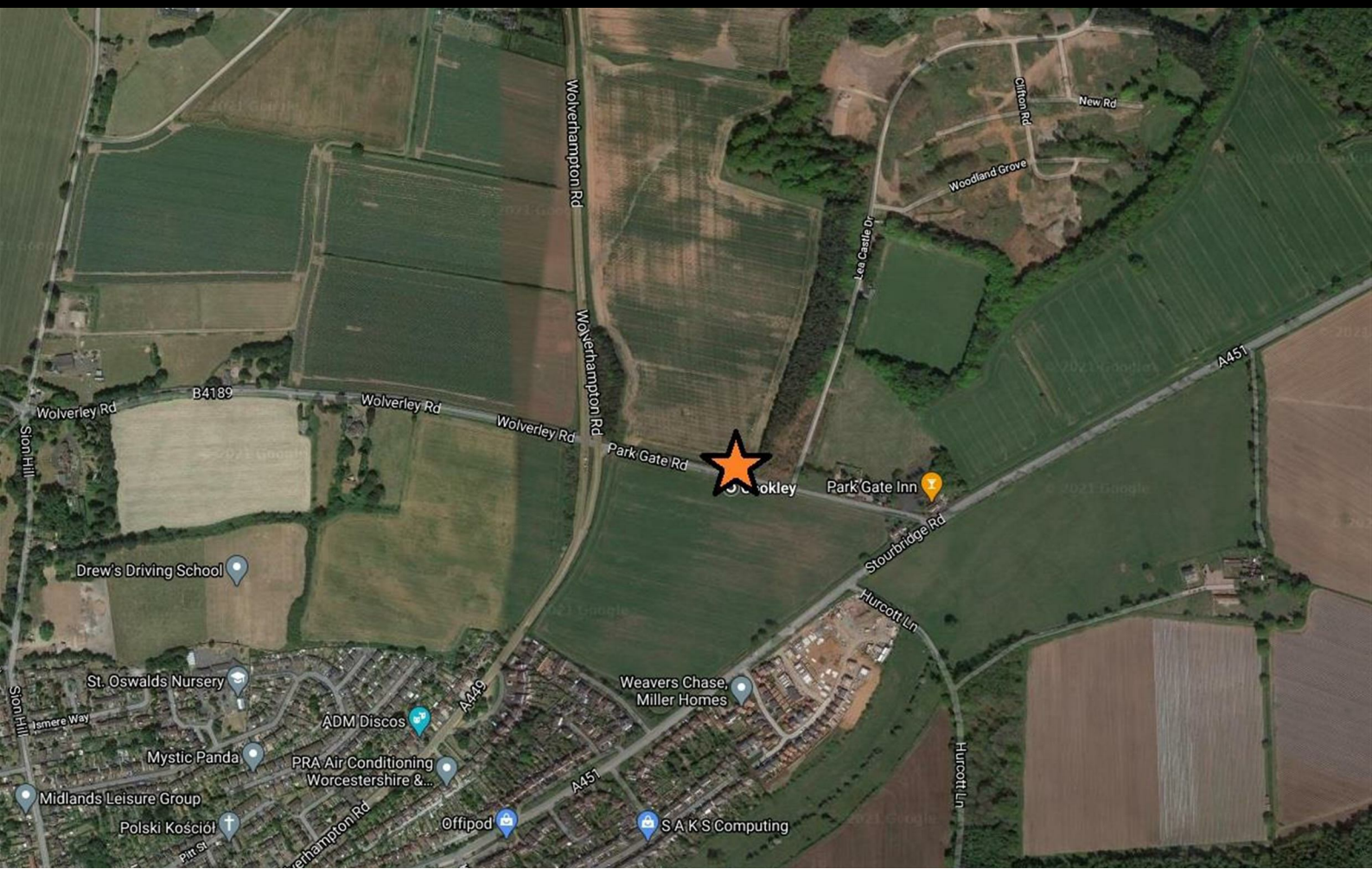

Floor Plan



Area Map



**Viewing**  
Please contact our Sales Advisor Kellie on 07807 787747 if you wish to arrange a viewing appointment for this property or require further information.

Energy Efficiency Graph

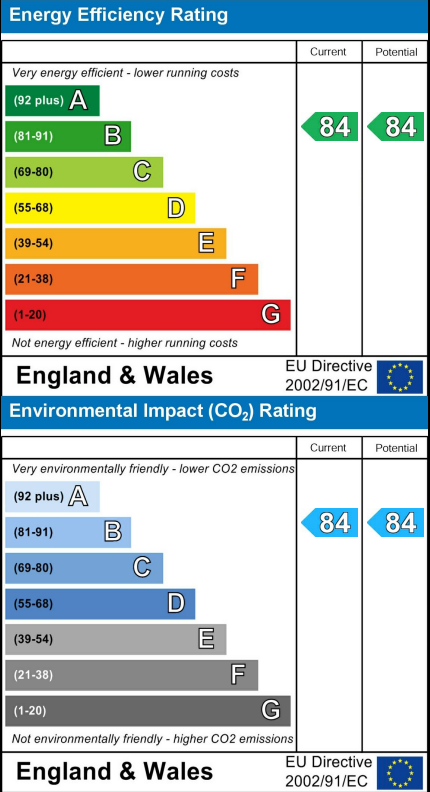

These particulars, whilst believed to be accurate are set out as a general outline only for guidance and do not constitute any part of an offer or contract. Intending purchasers should not rely on them as statements of representation of fact, but must satisfy themselves by inspection or otherwise as to their accuracy. No person in this firms employment has the authority to make or give any representation or warranty in respect of the property.

4040 Lakeside, Solihull, West Midlands, B37 7YN  
Email: [sales@citizenhousing.org.uk](mailto:sales@citizenhousing.org.uk) or visit [www.citizenhousing.org.uk](http://www.citizenhousing.org.uk)



## Plot 286 Park Gate - 40% share "The Hardwick"

3 Fern Close, Lea Castle, Kidderminster, DY10 3FU

**40% Shared ownership £95,598**



2



1



1



B

# Plot 286 Park Gate - 40% share "The Hardwick"



## Description

Plot 286-Park Gate - 40% share available £95,598  
Total Rent £382.34 pcm

Ready to Occupy October 2024 - AVAILABLE TO RESERVE NOW

If you would like to apply for this property, please complete our online application form via our Signature Website

You will need to also register with the local authority to purchase a property on this development, please visit - [www.homechoiceplus.org.uk/householdregistrationform](http://www.homechoiceplus.org.uk/householdregistrationform)

- Vinyl flooring to wet areas
- En suite to master bedroom
- Turf to front and rear gardens
- 1.8m Fencing to rear gardens
- 2 Parking spaces
- 2 spacious bedrooms
- Semi detached
- Downstairs cloakroom
- Brushed steel oven, ceramic hob & extractor
- near Kidderminster

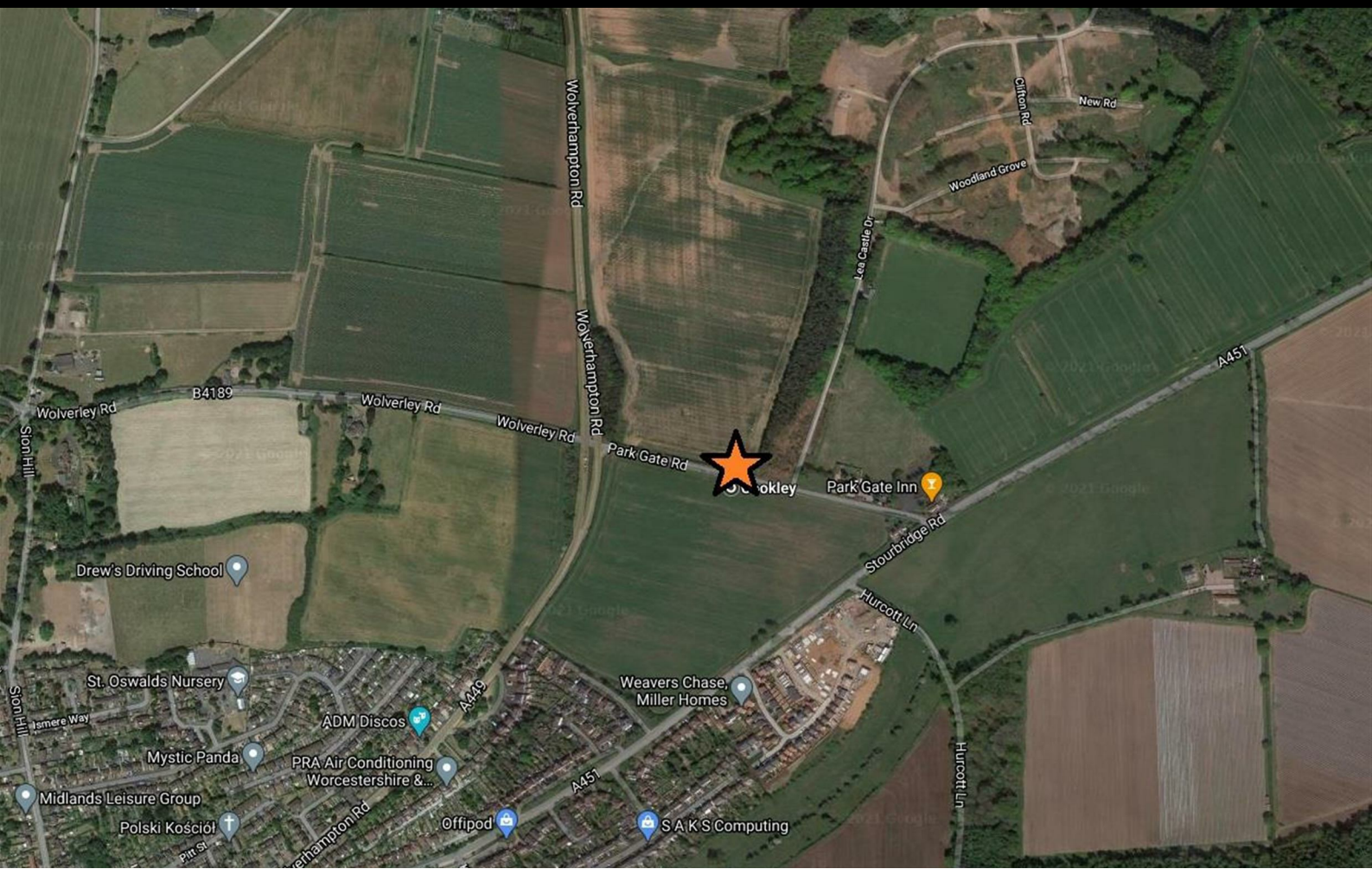

Floor Plan



Area Map

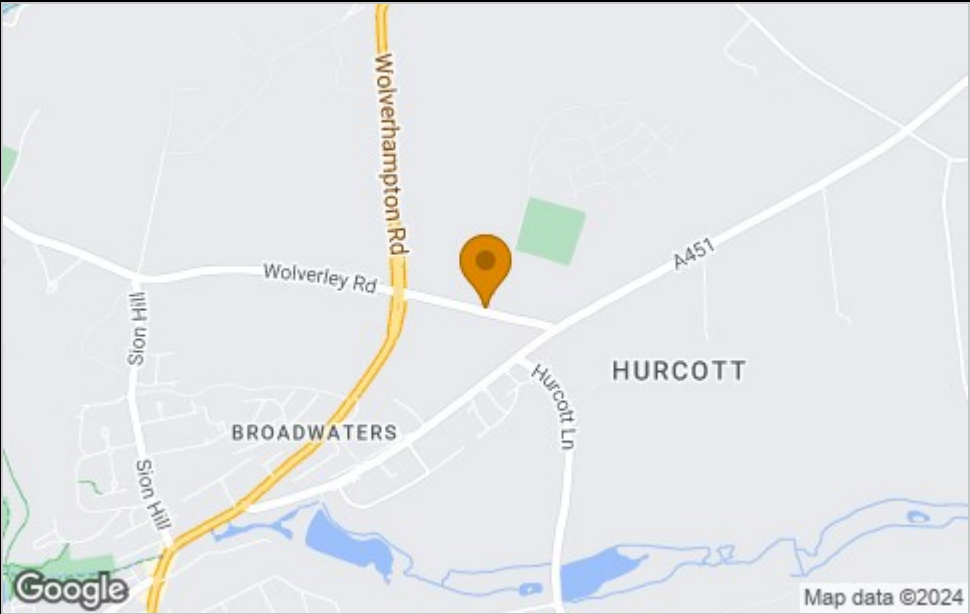

Energy Efficiency Graph

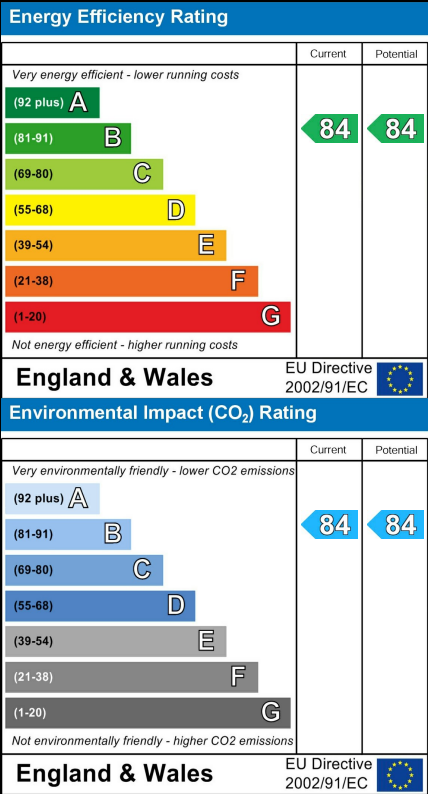

Viewing

Please contact our Sales Advisor Kellie on 07807 787747 if you wish to arrange a viewing appointment for this property or require further information.

These particulars, whilst believed to be accurate are set out as a general outline only for guidance and do not constitute any part of an offer or contract. Intending purchasers should not rely on them as statements of representation of fact, but must satisfy themselves by inspection or otherwise as to their accuracy. No person in this firms employment has the authority to make or give any representation or warranty in respect of the property.

4040 Lakeside, Solihull, West Midlands, B37 7YN  
Email: sales@citizenhousing.org.uk or visit www.citizenhousing.org.uk



## Plot 288 Park Gate- "The Francis" 35% share

33 Bluebell Crescent, Lea Castle, Kidderminster, DY10 3FD

**35% Shared ownership £98,875**



3



1



1



B

# Plot 288 Park Gate- "The Francis" 35% share

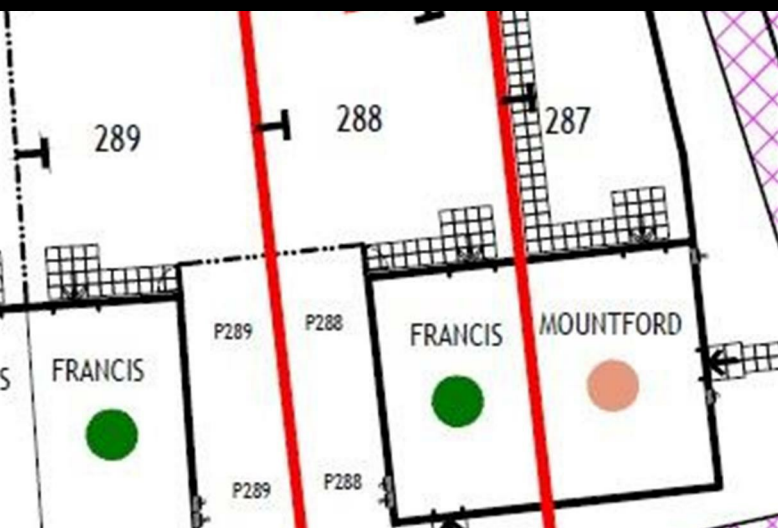

## Description

Plot 288 Park Gate "Francis" Purchase Price £98,875 35% share

Total Rent £476.32 pcm

Ready to Occupy Sept/Oct 2024 - AVAILABLE TO RESERVE NOW

If you would like to apply for this property, please complete our online application form via our Signature Website

You will need to also register with the local authority to purchase a property on this development, please visit [www.homechoiceplus.org.uk/householdregistrationform](http://www.homechoiceplus.org.uk/householdregistrationform)

- Vinyl flooring to wet areas
- Turf to front and rear gardens
- 2 Parking spaces
- Semi Detached
- Brushed steel oven, ceramic hob & extractor
- Ensuite to master bedroom
- 1.8m Fencing to rear gardens
- Ensuite to master bedroom
- Downstairs cloakroom
- Near Kidderminster



Floor Plan

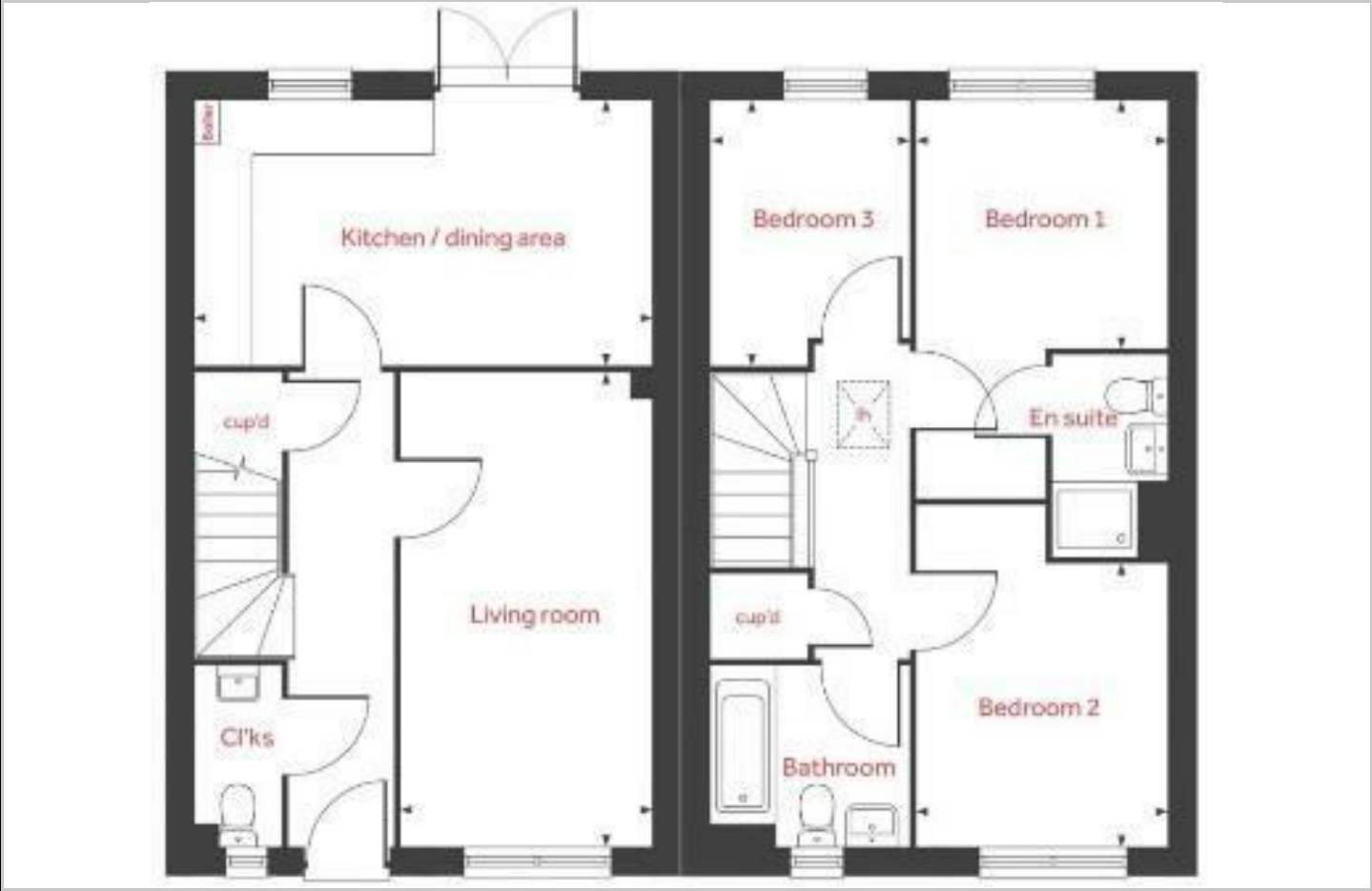

Area Map



Viewing

Please contact our Sales Advisor Kellie on 07807 787747 if you wish to arrange a viewing appointment for this property

These particulars, whilst believed to be accurate are set out as a general outline only for guidance and do not constitute any part of an offer or contract. Intending purchasers should not rely on them as statements of representation of fact, but must satisfy themselves by inspection or otherwise as to their accuracy. No person in this firms employment has the authority to make or give any representation or warranty in respect of the property.

4040 Lakeside, Solihull, West Midlands, B37 7YN  
Email: [sales@citizenhousing.org.uk](mailto:sales@citizenhousing.org.uk) or visit [www.citizenhousing.org.uk](http://www.citizenhousing.org.uk)

Energy Efficiency Graph

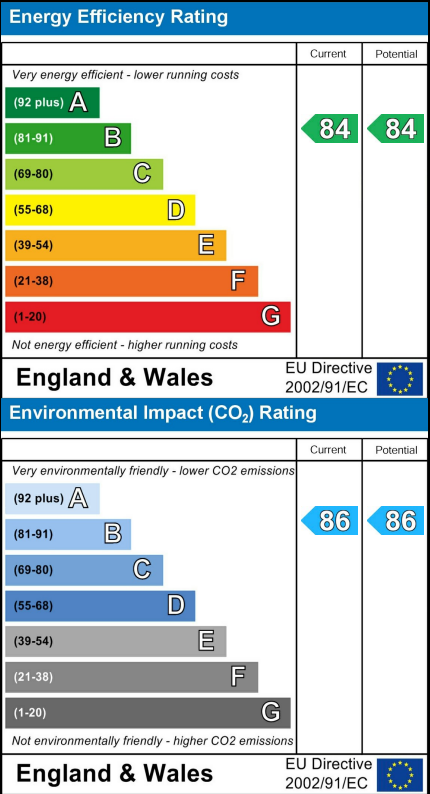



## Plot 289 Park Gate- "The Francis" 35% share

31 Bluebell Crescent, Lea Castle, Kidderminster, DY10 3FD

**35% Shared ownership £98,875**



3



1



1



B

# Plot 289 Park Gate- "The Francis" 35% share

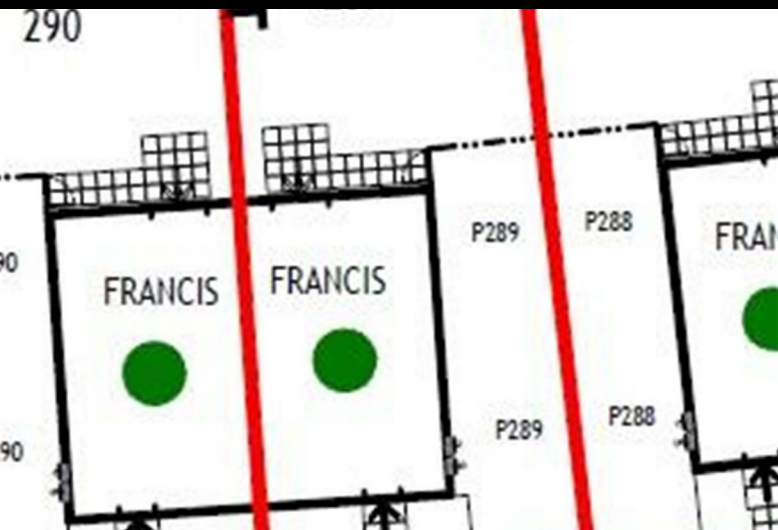

## Description

Plot 289 Park Gate - "Francis" Purchase Price £98,875 35% share  
Total Rent £476.32 pcm

Ready to Occupy September/October 2024 - AVAILABLE TO RESERVE NOW

If you would like to apply for this property, please complete our online application form via our Signature Website

You will need to also register with the local authority to purchase a property on this development, please visit [www.homechoiceplus.org.uk/householdregistrationform](http://www.homechoiceplus.org.uk/householdregistrationform)

- Vinyl flooring to wet areas
- New Build
- Turf to front and rear gardens
- 1.8m Fencing to rear
- 2 Parking spaces
- Ensuite to master bedroom
- Semi Detached
- Downstairs cloakroom
- Brushed steel oven, hob & extractor
- Near Kidderminster



Floor Plan

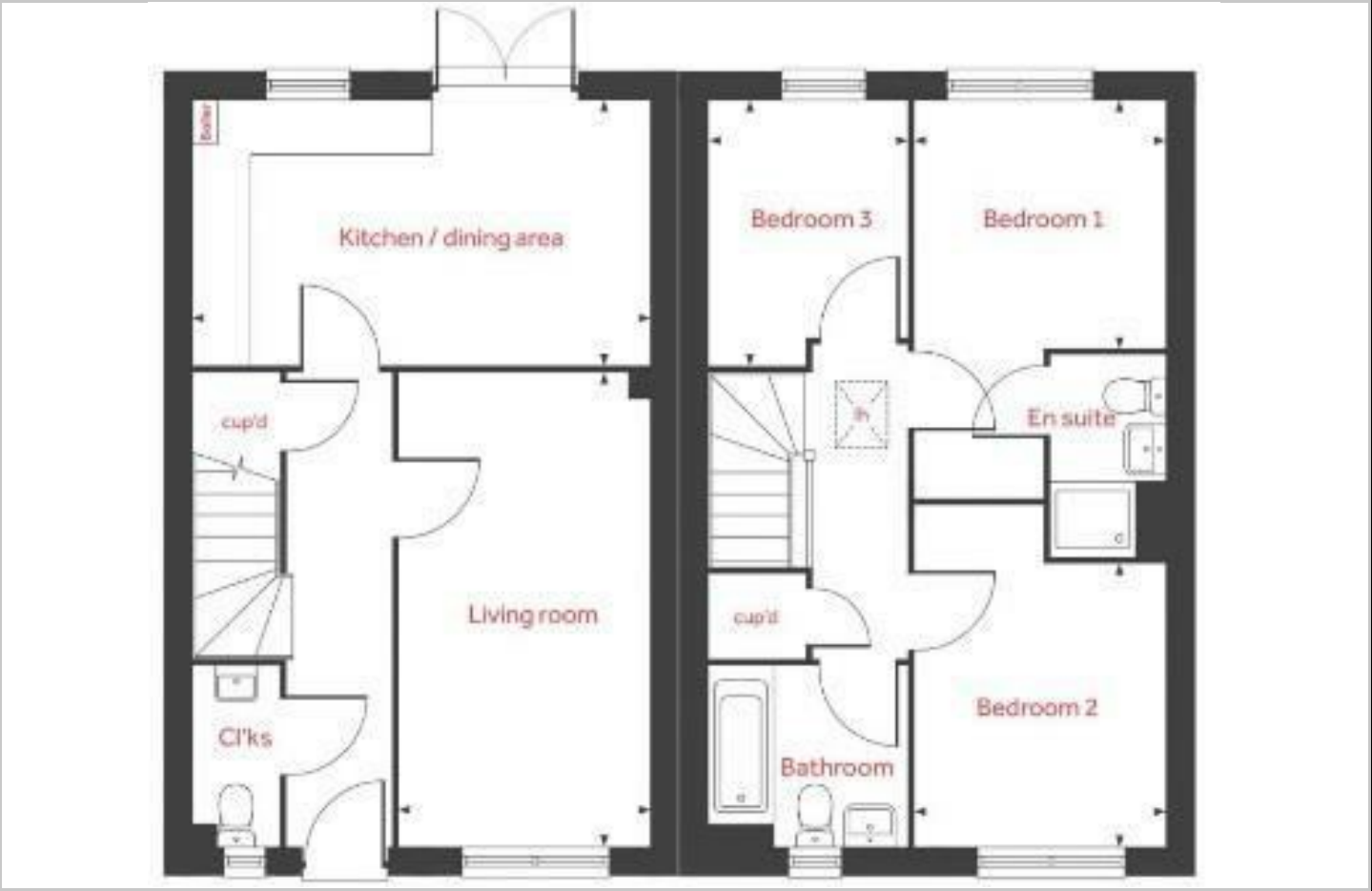

Area Map



Viewing

Please contact our Sales Advisor Kellie on 07807 787747 if you wish to arrange a viewing appointment for this property

These particulars, whilst believed to be accurate are set out as a general outline only for guidance and do not constitute any part of an offer or contract. Intending purchasers should not rely on them as statements of representation of fact, but must satisfy themselves by inspection or otherwise as to their accuracy. No person in this firms employment has the authority to make or give any representation or warranty in respect of the property.

4040 Lakeside, Solihull, West Midlands, B37 7YN  
Email: [sales@citizenhousing.org.uk](mailto:sales@citizenhousing.org.uk) or visit [www.citizenhousing.org.uk](http://www.citizenhousing.org.uk)

Energy Efficiency Graph

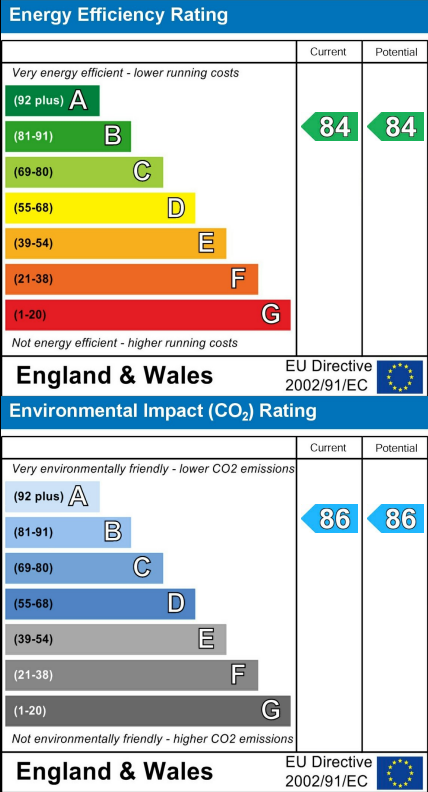



## Plot 290 Park Gate- "The Francis" 35% share

29 Bluebell Crescent, Lea Castle, Kidderminster, DY10 3FD

**35% Shared ownership £98,875**



3



1



1



B

# Plot 290 Park Gate- "The Francis" 35% share

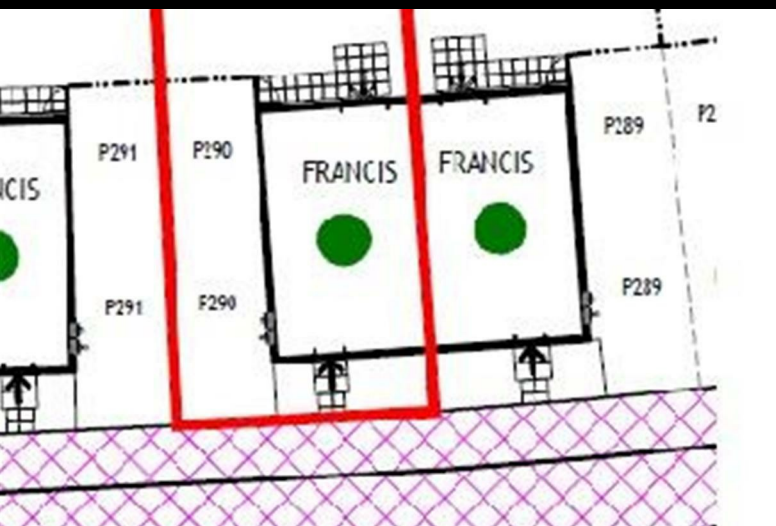

## Description

Plot 290 Park Gate - "Francis"

Purchase Price £98,875 35% share Total Rent £476.32 pcm  
Ready to Occupy September/October 2024 - AVAILABLE TO RESERVE NOW

If you would like to apply for this property, please complete our online application form via our Signature Website

You will need to also register with the local authority to purchase a property on this development, please visit [www.homechoiceplus.org.uk/householdregistrationform](http://www.homechoiceplus.org.uk/householdregistrationform)

- Vinyl flooring to wet areas
- New Build
- Turf to front and rear gardens
- 1.8m Fencing to rear gardens
- 2 Parking spaces
- Ensuite to master bedroom
- Semi Detached
- Downstairs cloakroom
- Brushed steel oven, hob & extractor
- Near Kidderminster



Floor Plan

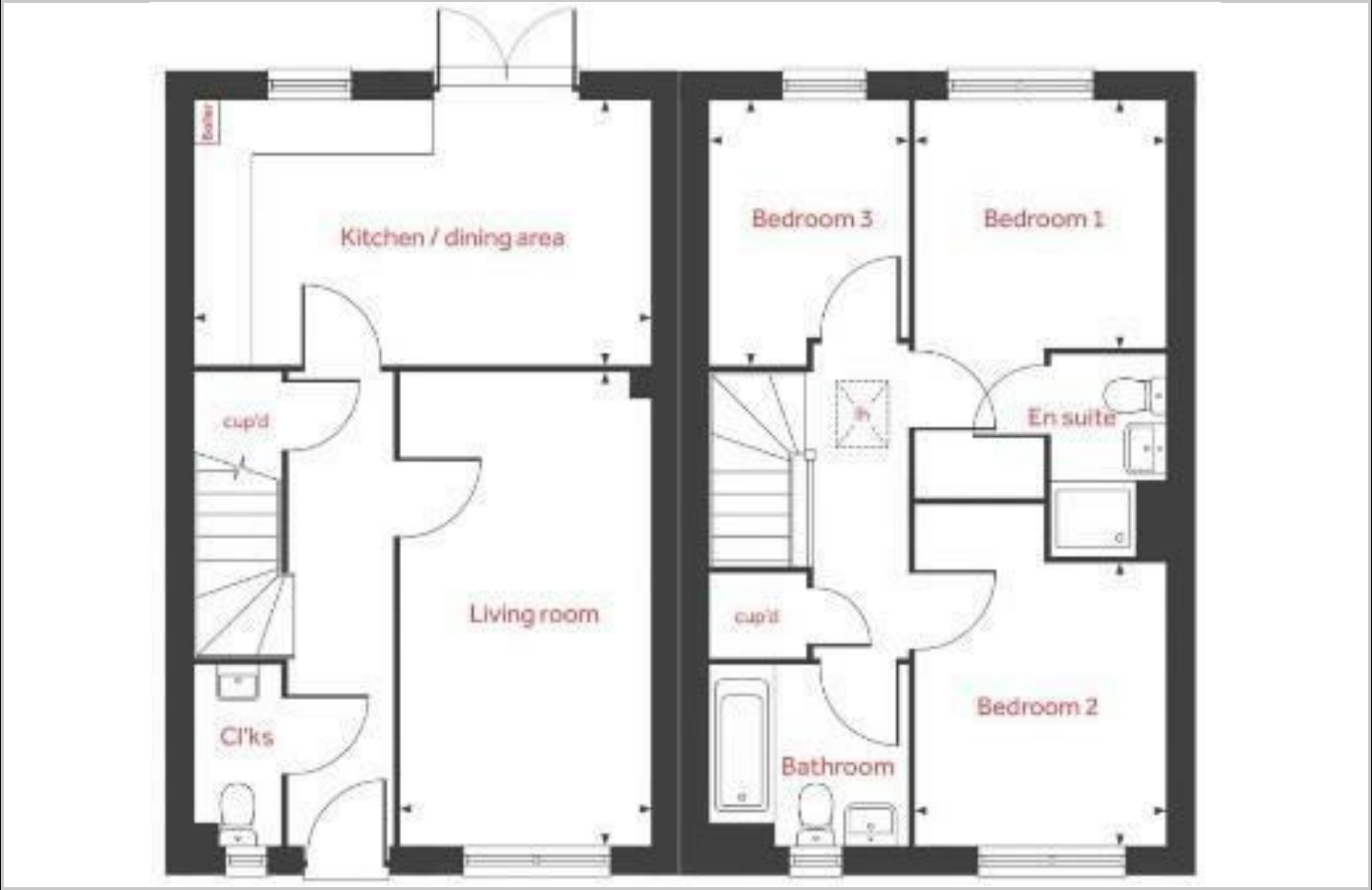

Area Map

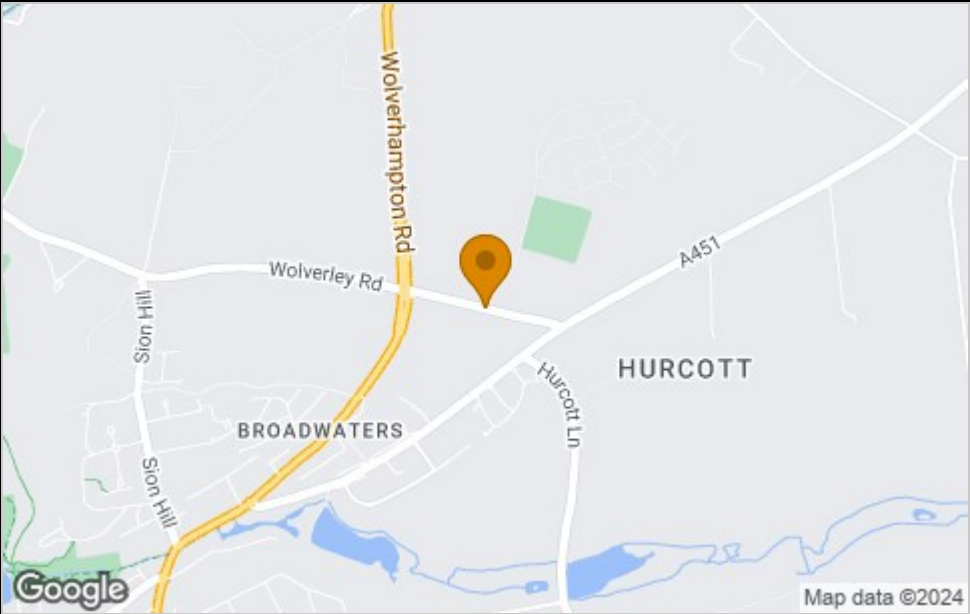

Viewing

Please contact our Sales Advisor Kellie on 07807 787747 if you wish to arrange a viewing appointment for this property

These particulars, whilst believed to be accurate are set out as a general outline only for guidance and do not constitute any part of an offer or contract. Intending purchasers should not rely on them as statements of representation of fact, but must satisfy themselves by inspection or otherwise as to their accuracy. No person in this firms employment has the authority to make or give any representation or warranty in respect of the property.

4040 Lakeside, Solihull, West Midlands, B37 7YN  
Email: [sales@citizenhousing.org.uk](mailto:sales@citizenhousing.org.uk) or visit [www.citizenhousing.org.uk](http://www.citizenhousing.org.uk)

Energy Efficiency Graph

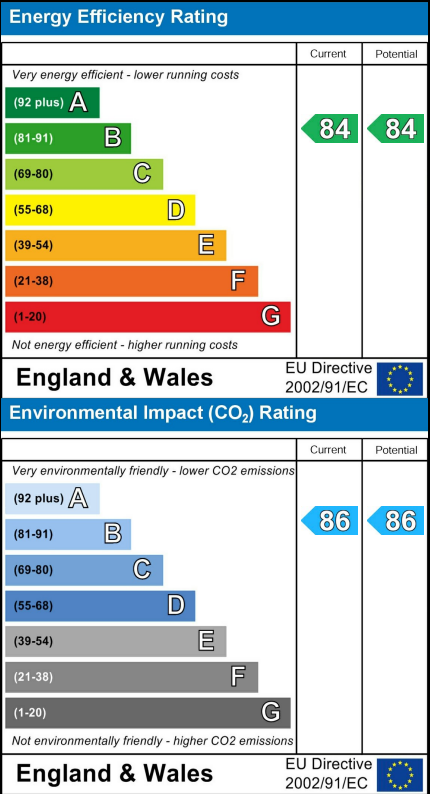



## Plot 451-Park Gate-40% share "The Hardwick"

14 Acorn Road, Lea Castle, Kidderminster, DY10 3FF

**40% Shared ownership £91,980**



# Plot 451-Park Gate-40% share "The Hardwick"

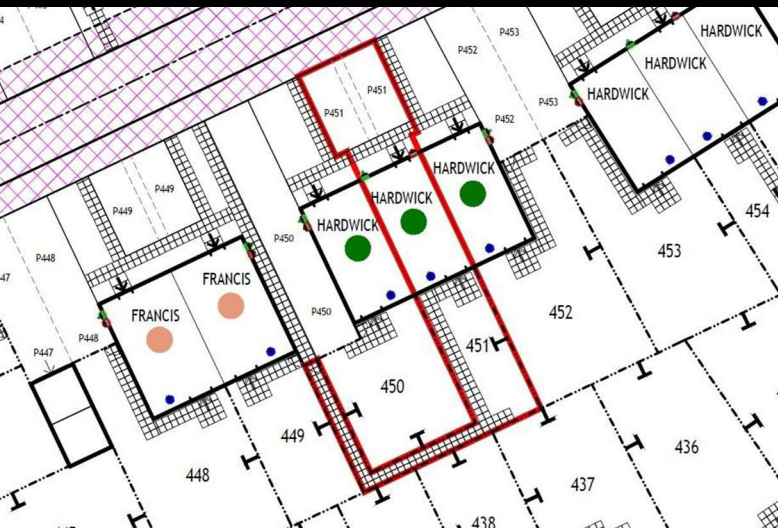

## Description

Plot 451-Park Gate - 40% share Purchase Price £91,980  
Total Rent £368.85pcm

### AVAILABLE NOW

If you would like to apply for this property, please complete our online application form via our Signature Website

You will need to also register with the local authority to purchase a property on this development, please visit - [www.homechoiceplus.org.uk/householdregistrationform](http://www.homechoiceplus.org.uk/householdregistrationform)

- Vinyl flooring to wet areas
- En suite to master bedroom
- Turf to front and rear gardens
- 1.8m Fencing to rear gardens
- 2 Parking spaces
- 2 spacious bedrooms
- Semi detached
- Downstairs cloakroom
- Brushed steel oven, ceramic hob & extractor
- near Kidderminster





Floor Plan



Area Map



Energy Efficiency Graph

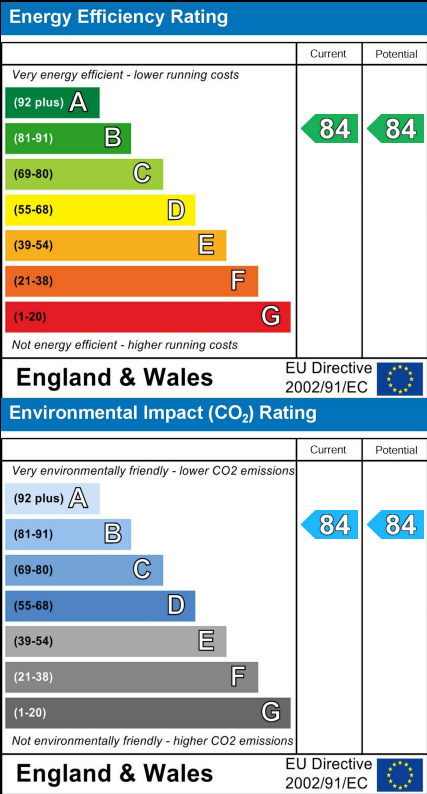

Viewing

Please contact our Citizen-Lea Castle Village, Kidderminster Office on 07807-787-747 if you wish to arrange a viewing appointment

These particulars, whilst believed to be accurate are set out as a general outline only for guidance and do not constitute any part of an offer or contract. Intending purchasers should not rely on them as statements of representation of fact, but must satisfy themselves by inspection or otherwise as to their accuracy. No person in this firms employment has the authority to make or give any representation or warranty in respect of the property.

4040 Lakeside, Solihull, West Midlands, B37 7YN  
Email: sales@citizenhousing.org.uk or visit www.citizenhousing.org.uk

