



CITIZEN



## Plot 34 Steeples Green "Bushmills" - 40% Share

32 Hollyberry Way, off Pickford Green Lane, Coventry, CV5 9PY

**40% Shared ownership £110,000**



2



1



1



B



# Plot 34 Steeples Green "Bushmills" - 40% Share



## Description

Plot 34 Steeples Green "Bushmills" Purchase Price £110,000 40% share  
Total Rent £436.50 pcm

Ready to occupy March 2024 - AVAILABLE TO RESERVE NOW

If you would like to apply for this property, please complete our online application form via our Signature Website

- Mid Terrace
- Vinyl flooring to wet areas
- Turf to rear garden
- near Coventry
- Downstairs cloakroom
- 2 parking spaces
- Oven hob & extractor included
- New build
- Good transport links
- 2 spacious bedrooms



32 Hollyberry Way, off Pickford Green Lane, Coventry, CV5 9PY





## Floor Plan

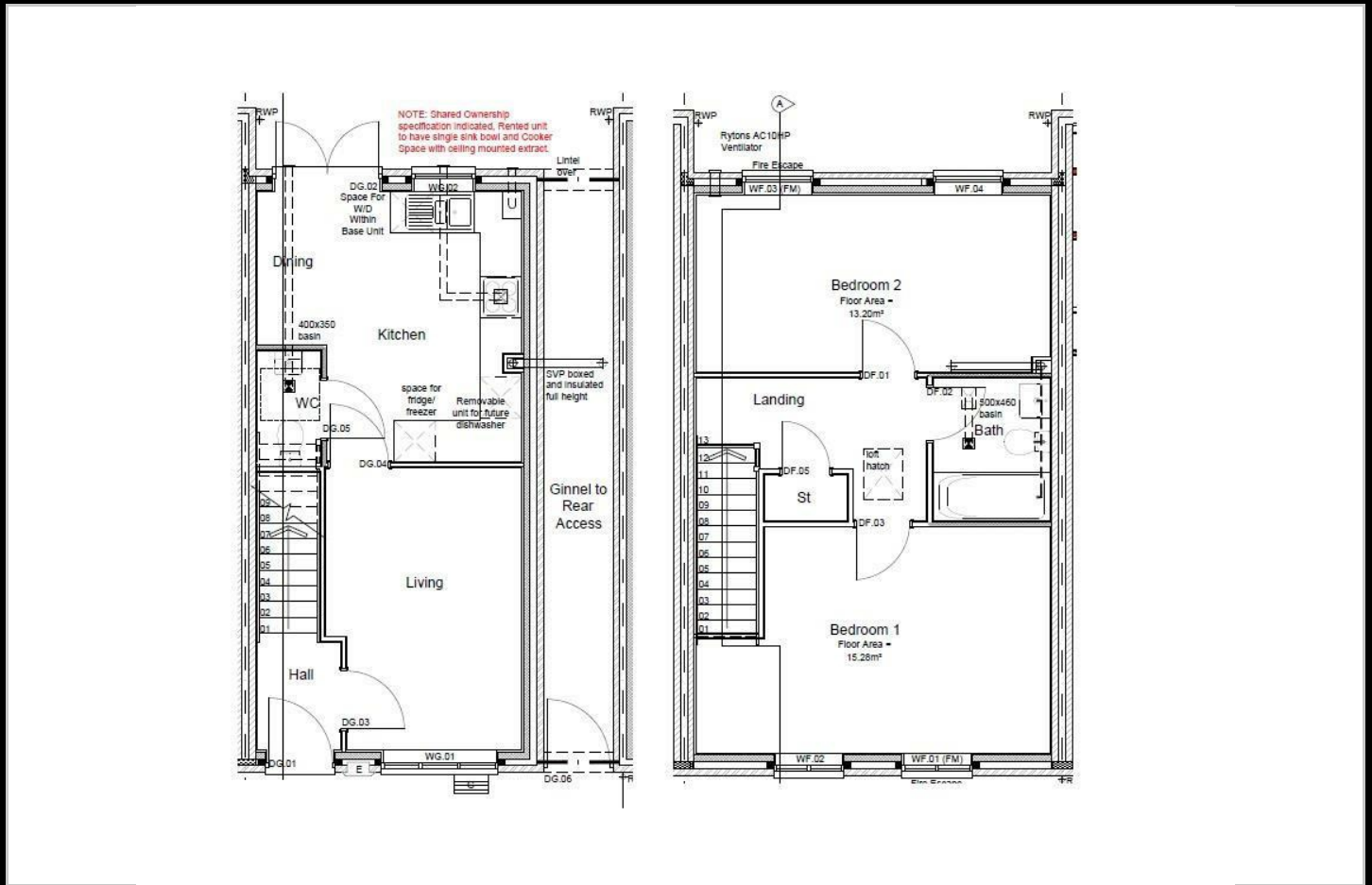

## Area Map

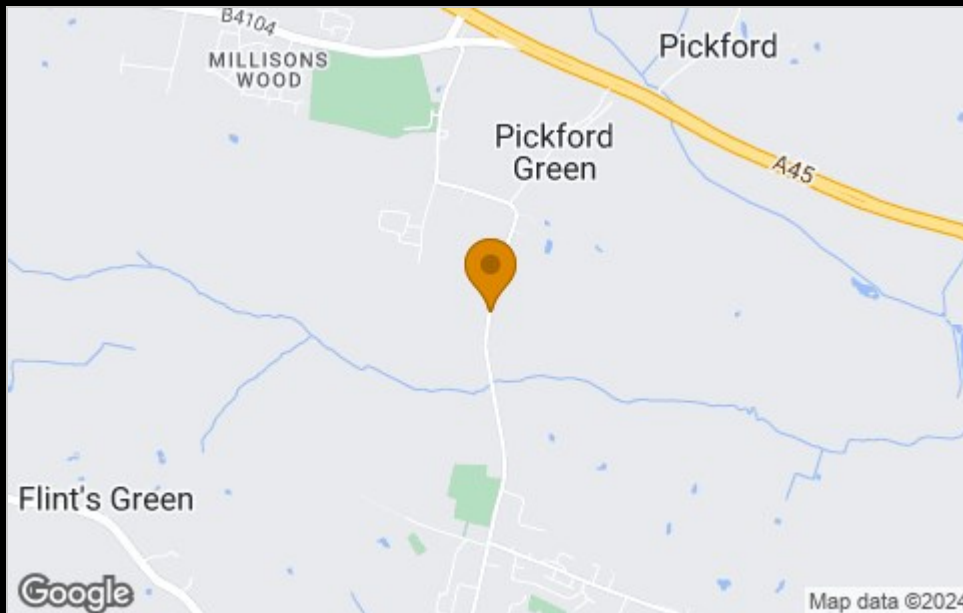

## Viewing

Please contact our Sales Advisor Teresa on 07736 792306 if you wish to arrange a viewing appointment for this property or require further information.

These particulars, whilst believed to be accurate are set out as a general outline only for guidance and do not constitute any part of an offer or contract. Intending purchasers should not rely on them as statements of representation of fact, but must satisfy themselves by inspection or otherwise as to their accuracy. No person in this firm's employment has the authority to make or give any representation or warranty in respect of the property.

4040 Lakeside, Solihull, West Midlands, B37 7YN

Email: [sales@citizenhousing.org.uk](mailto:sales@citizenhousing.org.uk) or visit [www.citizenhousing.org.uk](http://www.citizenhousing.org.uk)

## Energy Efficiency Graph

